

557.50



EN 71

ASTM
F963



- DK** Reservedele
- GB** Spare Parts
- DE** Ersatzteile

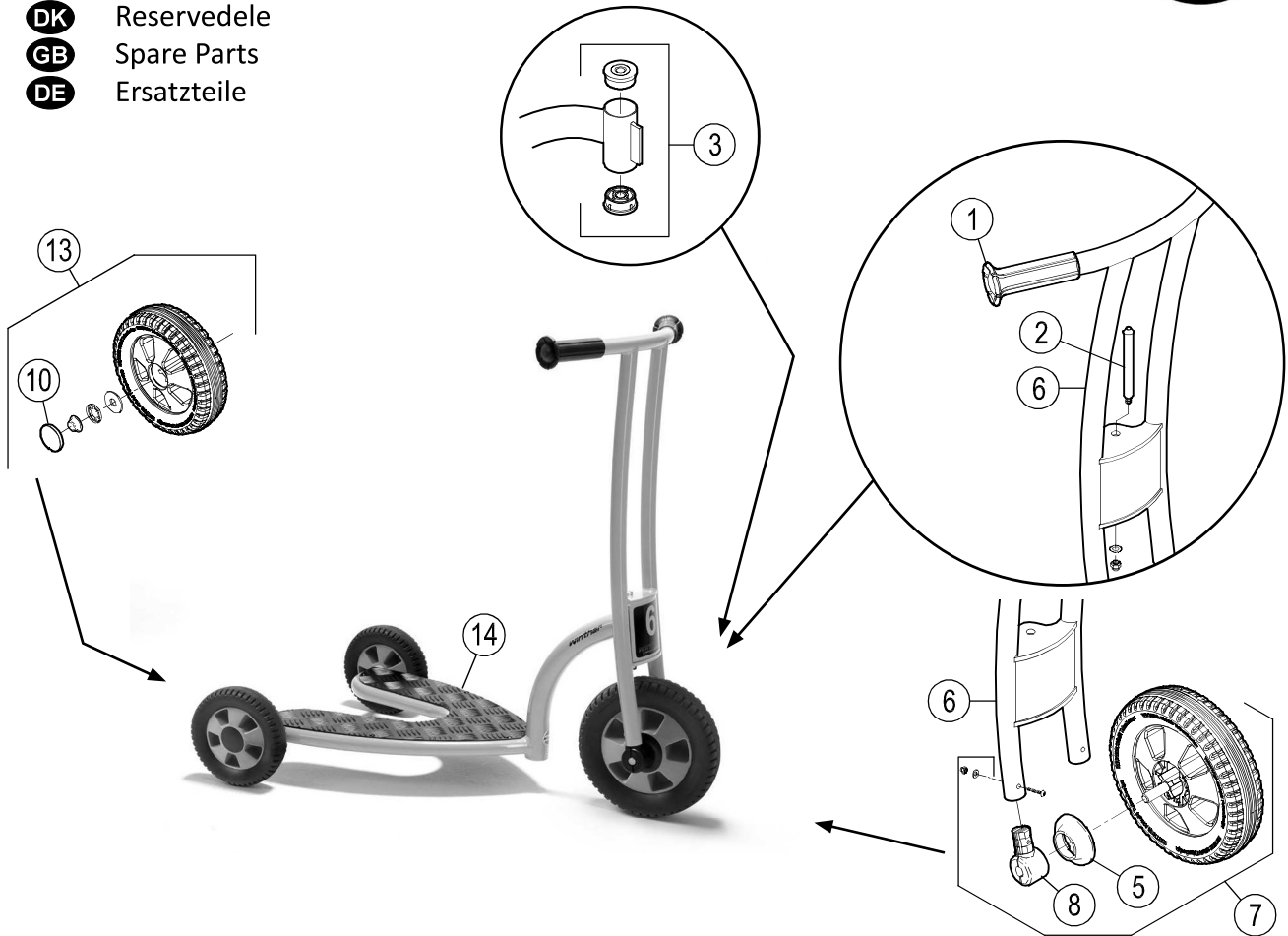

Pos.		Pos.	
1	x2 x2	8	x2 x2 x1
2	x1 x2 x1 x1 x1	9	
3	x2	10	x2
4		11	
5	x2	12	
6		13	
7		14	

557.50



EN 71

ASTM
F963



- DK** Reservedele
- GB** Spare Parts
- DE** Ersatzteile

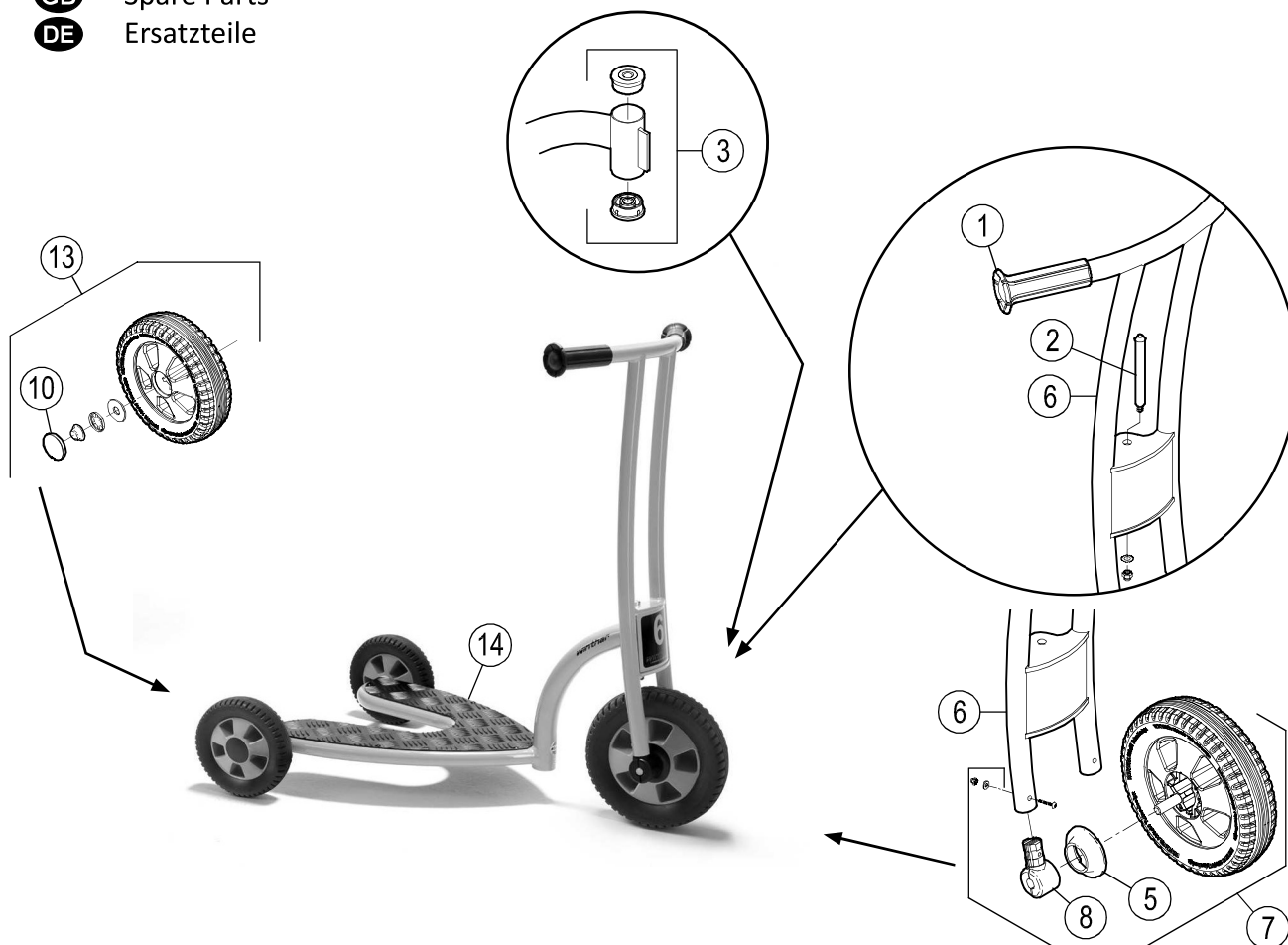

557.50					
Version					
Pos.	1.0	1.1			
1	50403	50403			
2	50401	50401			
3	50404	50404			
4	-	-			
5	50270	50270			
6	50454	50454			
7	50280	50280			
8	50406	50406			
9	-	-			
10	50284	50284			
11	-	-			
12	-	-			
13	50297	50297			
14	50487	50487			
15	-	-			

